

CHESTER TOWNSHIP	MARCH	ONE
	1997	ONE
SURVEY FOR WILLIAM J. THOMPSON		DRAWN BY: RLK/CAD

PLAT OF SURVEY PREPARED FOR: WILLIAM J. AND JOYCE L. THOMPSON

R. AND B. TARAJCAK 733-1049

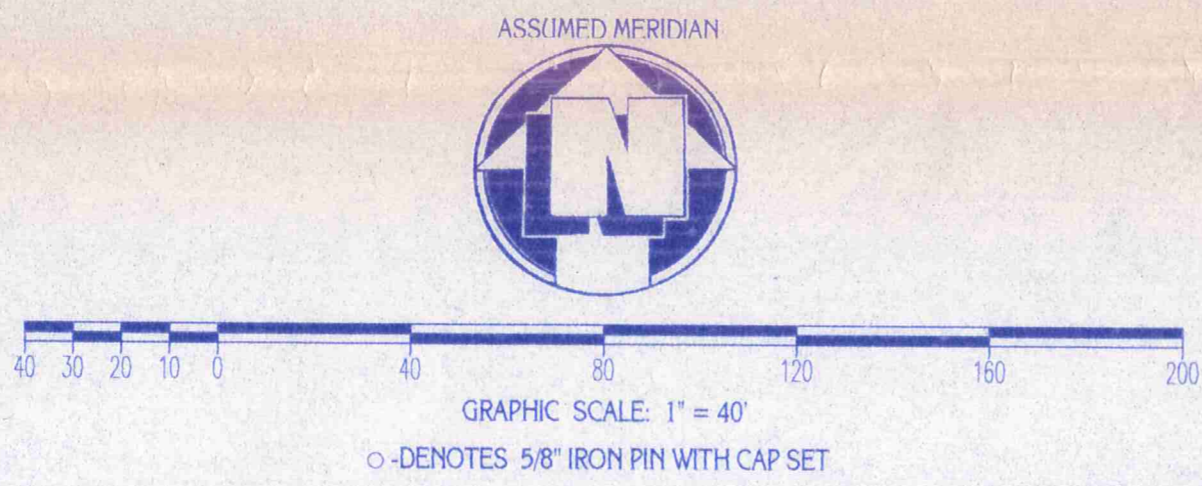

SITUATED IN THE TOWNSHIP OF CHESTER,
COUNTY OF GEauga AND STATE OF OHIO
AND KNOWN AS BEING PART OF ORIGINAL LOT
NO. 29, IN TRACT NO. 1, AND LOT NO. 18 AND 19,
IN TRACT NO. 2, WITHIN SAID TOWNSHIP.

PLAT OF SURVEY PREPARED BY:
DELMAR B. KOSIE AND ASSOCIATES
200 SOUTH STREET
CHARDON, OHIO 44024
PHONE: 216-286-2131

D.L. ZWICK 798-1256

D. AND M. POLEY 734-1119

5.8675 ACRE PARCEL

DEED OF RECORD: VOLUME 501, PAGE 932, DEED OF RECORD: VOLUME 501, PAGE 928 AND DEED OF RECORD: VOLUME 501, PAGE 930

RIGHT-OF-WAY CURVE:
RADIUS: 507.46' calc.
DELTA: 18°-36'12" calc.
LENGTH: 164.77' calc.
CHORD: 164.04' calc.
BEARING: N 64°34'46" E calc.

CENTERLINE CURVE:
RADIUS: 477.46' rec.
DELTA: 18°-36'12" rec.
LENGTH: 155.03' rec.
CHORD: 154.35' rec.
BEARING: N 64°34'46" E rec.

CENTERLINE CURVE:
RADIUS: 859.33' calc.
DELTA: 01°-21'-20" calc.
LENGTH: 20.33' calc.
CHORD: 20.33' calc.
BEARING: N 55° 57'20" E calc.

7.20' calc.
1 1/4" IRON PIPE FD.
ON PROPERTY LINE
5/8" IRON PIN SET
1" IRON PIN IN
MONUMENT BOX
FD. AND USED

1" IRON PIN IN
MONUMENT BOX
FD. AND USED

EMERGENCY FOR EGRESS PURPOSES
VOL. 155, PG. 410

1 1/4" IRON PIPE FD.
ON PROPERTY LINE
5/8" IRON PIN SET

WILSON MILLS ROAD

MONUMENTS WERE FOUND OR SET AS INDICATED HEREON.
DISTANCES ARE IN FEET WITH DECIMAL PARTS.
BEARINGS ARE TO AN ASSUMED MERIDIAN AND INDICATE ANGLES ONLY.
I HEREBY CERTIFY THAT I HAVE SURVEYED THESE PREMISES AND
PREPARED THIS PLAT OF SURVEY IN ACCORDANCE WITH THE PROVISIONS
OF CHAPTER 4733-37 OF THE OHIO REVISED CODE.

SURVEY PLAT AND LEGAL
DESCRIPTION APPROVED
PER R.C. 315.251

R.S. 4/1/1997
GEAUGA COUNTY ENGINEER

Delmar B. Kosie
DELMAR B. KOSIE
REGISTERED SURVEYOR NO. 5276



CHE00147

(CHE
00147)

Thompson
picked up 4-2-1997
#11-343700

Delmar B. Kosie & Associates

200 South Street - Chardon, Ohio 44024

CORRECTIVE DEED

5.867 ACRE PARCEL

DEEDS OF RECORD: VOLUME 501, PAGE 932, VOLUME 501, PAGE 928 AND
VOLUME 501, PAGE 930

SITUATED IN THE TOWNSHIP OF CHESTER, COUNTY OF GEauga AND STATE OF OHIO AND KNOWN AS BEING PART OF ORIGINAL LOT NO. 29, IN TRACT NO. 1, AND ORIGINAL LOT NO. 18 AND 19, IN TRACT NO. 2 WITHIN SAID TOWNSHIP AND BOUNDED AND DESCRIBED AS FOLLOWS:

BEGINNING AT A POINT ON THE CENTERLINE OF WILSON MILLS ROAD (60 FEET WIDE). SAID POINT BEING THE SOUTHEASTERLY CORNER OF A PARCEL OF LAND CONVEYED TO D. AND M. POLEY AS RECORDED IN VOL. 734, PG. 1119 OF GEauga COUNTY RECORDS AND DEEDS.

THENCE N08 02'40"E ALONG SAID POLEYS' EASTERLY LINE AND ALSO ALONG AN EASTERLY LINE OF A PARCEL OF LAND CONVEYED TO D.L. ZWICK AS RECORDED IN VOL. 798, PG. 1256 OF GEauga COUNTY RECORDS AND DEEDS AND PASSING THROUGH A 5/8" IRON PIN SET AT 40.54 FEET AND ALSO PASSING THROUGH A 1 1/4" IRON PIPE FOUND AT 40.88 FEET A TOTAL DISTANCE OF 535.84 FEET TO A 1" IRON PIPE FOUND ON A SOUTHERLY LINE OF A PARCEL OF LAND CONVEYED TO M. ILIJAS AS RECORDED IN VOL. 846, PG. 467 OF GEauga COUNTY RECORDS AND DEEDS.

THENCE S84 38'47"E ALONG SAID ILIJAS' SOUTHERLY LINE A DISTANCE OF 150.15 FEET TO A 1" IRON PIPE FOUND.

THENCE N07 45'47"E ALONG AN EASTERLY LINE OF SAID ILIJAS' LAND A DISTANCE OF 200.13 FEET TO A 1 1/2" IRON PIPE FOUND ON A SOUTHERLY LINE OF A PARCEL OF LAND CONVEYED TO L. AND V. TAMARO AS RECORDED IN VOL. 709, PG. 1337 OF GEauga COUNTY RECORDS AND DEEDS.

THENCE S84 54'52"E ALONG SAID TAMARO'S SOUTHERLY LINE A DISTANCE OF 149.84 FEET TO A 1 1/4" IRON PIPE FOUND.

Delmar B. Kosie & Associates

CHE00147

200 South Street - Chardon, Ohio 44024

CORRECTIVE DEED CONTINUED **5.867 ACRE PARCEL**

DEEDS OF RECORD: VOLUME 501, PAGE 932, VOLUME 501, PAGE 928 AND
VOLUME 501, PAGE 930

THENCE N7 47'44"E ALONG AN EASTERLY LINE OF SAID TAMARO'S LAND A
DISTANCE OF 200.16 FEET TO A 1 3/4" IRON PIPE FOUND ON A SOUTHERLY
LINE OF A PARCEL OF LAND CONVEYED TO R. AND B. TARAJCAK AS
RECORDED IN VOL. 733, PG. 1049 OF GEAUGA COUNTY RECORDS AND
DEEDS.

THENCE S84 55'28"E ALONG SAID TARAJCAK'S SOUTHERLY LINE A
DISTANCE OF 150.12 FEET TO A 1 5/8" IRON PIPE FOUND ON A WESTERLY
LINE OF A PARCEL OF LAND CONVEYED TO N.F. AND F.J. SIMONE CO-
TRUSTEE AS RECORDED IN VOL. 734, PG. 1336 OF GEAUGA COUNTY
RECORDS AND DEEDS.

THENCE S07 55'32"W ALONG SAID SIMONE'S WESTERLY LINE AND PASSING
THROUGH A 5/8" IRON PIN SET AT 622.43 FEET AND ALSO PASSING
THROUGH A 1 1/4" IRON PIPE FOUND AT 622.71 FEET A TOTAL DISTANCE
OF 655.28 FEET TO A POINT ON THE CENTERLINE OF THE AFORESAID
WILSON MILLS ROAD.

THENCE S73 52'52"W ALONG SAID CENTERLINE A DISTANCE OF 178.66
FEET TO A P.T. OF A CURVE.

THENCE S64 34'46"W CONTINUING ALONG SAID CURVE, DEFLECTING TO
THE LEFT, HAVING A RADIUS OF 477.46 FEET, A DELTA OF 18-36'-12", AN
ARC DISTANCE OF 155.03 FEET AND A CHORD DISTANCE OF 154.35 FEET
TO THE P.C. OF SAID CURVE.

THENCE S55 16'40"W CONTINUING ALONG SAID CENTERLINE A DISTANCE
OF 193.71 FEET TO A P.T. OF A CURVE.

THENCE S55 57'20"W CONTINUING ALONG SAID CURVE, DEFLECTING TO
THE RIGHT, HAVING A RADIUS OF 859.33 FEET, A DELTA OF 1-21'-20", AN
ARC DISTANCE OF 20.33 FEET AND A CHORD DISTANCE OF 20.33 FEET TO
THE PRINCIPLE PLACE OF BEGINNING OF THIS SURVEY AND CONTAINING
5.867 ACRES OF LAND AS SURVEYED BY DELMAR B. KOSIE AND ASSOCIATES
(DELMAR B. KOSIE, REGISTERED SURVEYOR NO. 5276). MARCH, 1997.
BEARINGS ARE TO AN ASSUMED MERIDIAN AND INDICATE ANGLES ONLY.

SURVEY PLAT AND LEGAL
DESCRIPTION APPROVED
PER R.C. 315.251
R.S. 4/1/1997
GEAUGA COUNTY ENGINEER